

CP Geometry
Twists on SA and Volume

Name: _____

- 1.) The solid block below is 8" wide by 4" tall and 15" long. A circular hole is drilled out of the middle of the block with diameter 3". Find the surface area of the figure.

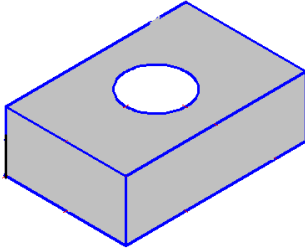

- 2.) A can is in the shape of a right cylinder. Suppose it is 12" tall and has a diameter of 5". Find the surface area of the outside of the can if someone removed the lid.

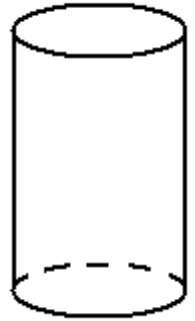

- 3.) A bowl is in the shape of a hemisphere with diameter 20". Find the outside surface area of the bowl.



- 4.) A spherical apple is cut in half. Find the surface area of one of the halves of the apple. (The radius is 4 cm.)

- 5.) Find the surface area of the cone-topped cylinder.

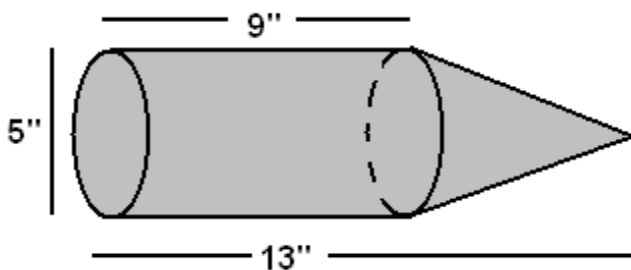

More Interesting Figures.

- 1.) A cone, oblique cylinder, and hemisphere.
Volume only.

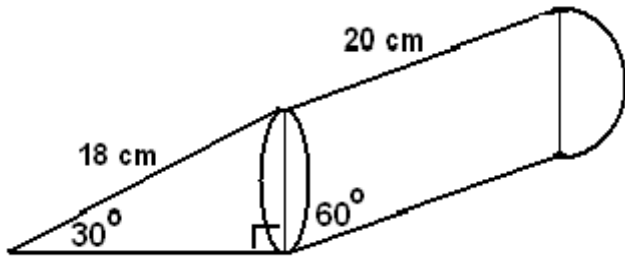

- 2.) An ice cream cone with a hemisphere (diameter 8 cm) and cone (height 10 cm)
Surface Area and Volume.



- 3.) In the following right cylinder, the "bottom" is normal but the top section consists of half a sphere opening inward.
Surface Area and Volume.

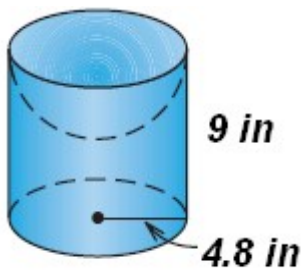

- 4.) Three spherical balls of wax are placed inside a cylinder. When the wax is melted, how tall in the cylinder is the liquid?

